



IMPORTANT SAFETY RECALL NOTICE

Subject Öhlins TTX36 Shock absorbers	Date 03/25/2015	Page 1(3)
Author Robert Brinkmark	Distribution TTX36 MC aftermarket Shock absorbers Owners	

Dear TTX 36 Shock Owner,

This notice is sent to you in accordance with the requirements of the National Traffic and Motor Vehicle Safety Act.

Öhlins Racing AB has determined that a defect which relates to motor vehicle safety exists in **certain batches and part numbers** of aftermarket TTX36 (TTX GP, TTX RT & TTX36 MKII) MC shock absorbers produced between 11-06-2013 and 02-19-2015.

Öhlins Racing AB is conducting a campaign to recall all the affected aftermarket TTX36 shock absorbers of the models and batches listed below to rectify the issue.

The cause for this defect is the piston-shaft nut which in some cases has not been torqued at full metal to metal contact because the top out spring is preventing the piston to reach its final position due to high friction.

Component assembly shown in figure below.

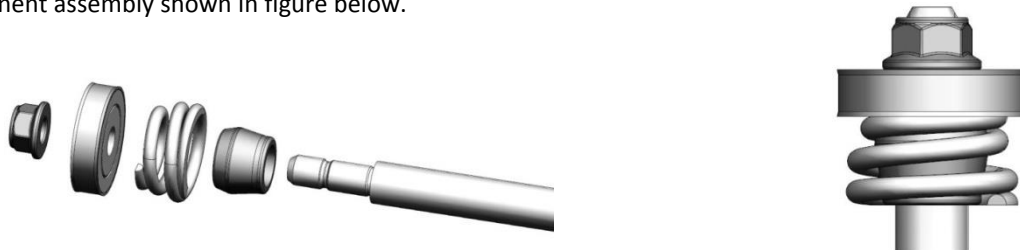

IMPORTANT NOTICE!

If the piston-shaft nut comes lose the result will be loss of damping and on some applications it can also cause the shock absorber to come apart. Either of these events may surprise the rider in a way that the rider would no longer have full control of the motorcycle, increasing the risk of a crash.

We therefore strongly urge you to stop using the bike until the shock absorber has been removed or corrected! It can be a safety issue to use the bike with the faulty shock absorber on the bike.

This assembly defect has been rectified and the issue does not exist on shock absorbers with an earlier or a later batch number.

Batch numbers for the shock absorbers in question can be found below.

You can find the batch number on the shock absorber, stamped on the cylinder head, near the top mounting bolt.



Subject Öhlins TTX36 Shock absorbers	Date 03/25/2015	Page 2(3)
---	--------------------	--------------

Steps You Need To Take:

If you own a shock absorber included in the list below, the TTX 36 Recall Form is attached, please ***include this form when you ship your shock absorber.***

Ship to the address on the form. This is important in order to track your claim and return the shock absorber to you in a timely fashion.

You will not bear any costs for this. Öhlins Racing AB will cover all costs related to removing and correcting the shock absorber.

If you no longer are the owner of the bike with this shock absorber mounted, please provide us with information about the new owners, using the contact details below.

If you have any further questions regarding this, please contact us using the contact details below.

If you are the lessor of this vehicle, please forward a copy of this notice to the lessee within ten days to comply with federal regulations.

If you have already paid to have your shock absorber repaired for this condition, you may be eligible for reimbursement of the charges you paid for the repair. To learn more about what you need to do to obtain reimbursement, contact Öhlins USA. Contact details below.

If after having attempted to take advantage of this recall you believe you have not been able to have your shock absorber remedied without charge and within a reasonable amount of time, you may submit a complaint to the Administrator, National Highway Traffic Safety Administration, 1200 New Jersey Ave., S.E.; Washington D.C., 20590; or call the toll-free Vehicle Safety Hotline at 1-888-327-4236 (TTY: 1-800-424-9153); or go to <http://www.safercar.gov>

We apologize for any inconvenience this safety recall may cause, but your safety is our first concern.

Yours sincerely

Öhlins Racing AB

Öhlins USA Inc. 703 South Grove St. Hendersonville, NC 28792 Ph. 800-336-9029 x309

<http://www.ohlinsusa.com>



INFORMATION

Subject Öhlins TTX36 Shock absorbers	Date 03/25/2015	Page 3(3)
---	--------------------	--------------

Part and batch numbers for shock absorbers to be recalled

Part No	Batch number(s)
AP 340	136734 136735 137254 138061 309524
BM 147	137936
BM 340	136737 136739 137874 138320
BM 342	136741 137875
BM 343	136742 136920
BM 345	309605
BM 677	138736
DU 339	309611
DU 339P	137191 137494 309541
DU 340	136743 136744 137149 137495 309528
DU 868 (DU 871)	136527 138064
HO 339	136745 136746 136747 309529
HO 340	136749 136753 136754 137163 137593 309530
HO 358	137513 138121 309517
KA 035	136126 137366 138068
KA 040	137030 137735
KA 336	136755 136756 137268 138613 309531
KA 338	136757 137741 309532
KA 340	136758 136759 136760 136761 137031 137515 137822 137904 138293 309533
KA 358	137070
KA 788	137518
SU 026	137752 138791
SU 339	136762 136763 137521 137753 309534
SU 340	136764 136765 137522
SU 357	309522
SU 789	138770
SU 932	137523
TR 338	309584
TR 339	136770 309536
YA 339	136771 136772 136774 136775 136924 137185 137528 137933 309537 309610
YA 340	136776 136777 136778 137912 138631 309538
YA 358	309519
YA 359	309563
YA 931	135517